



TKC-EKA series dismountable hall effect current sensor is an open loop device based on the measuring principle of the hall effect, with a galvanic isolation between primary and secondary circuit. It provides accurate electronic measurement of DC, AC or pulsed currents.

Electrical data (Ta=25 °C±5°C,RL=2KΩ, C L=10000PF)

Type	TKC100EKA	TKC200EKA	TKC300EKA	TKC400EKA	TKC500EKA	Unit
Rated current (Ipn)	±50	±100	±300	±400	±500	A
Measure range (Ip)	±100	±200	±600	±800	±1000	A
Rated output	@Ip=±Ipn ±4±1%					V
Supply voltage	±15±5%					V
Power Consumption	+25,-10					mA
Offset voltage	@Ip=0 ±20					mV
Magnetic offset	@Ip=±Ipn-0 ±20					mV
Offset drift	@-40 ~ +85°C ≤±1					mV/°C
Output drift	@-40 ~ +85°C ≤±1					mV/
Linearity	@Ip=0-±Ipn ≤1					%FS
Response time	@50A/μS, 10%-90% ≤5					μS
Galvanic isolation	@50HZ, AC,1min 2.5					KV
Band-width	@(-3dB) DC-25					KHz
Isolation resistance	@ DC 500V 1000					MΩ

Applications

- Variable speed drives
- Welding machine
- Battery supplied applications
- Uninterruptible Power Supplies (UPS)
- Electrochemical

Mechanical dimension (for reference only)

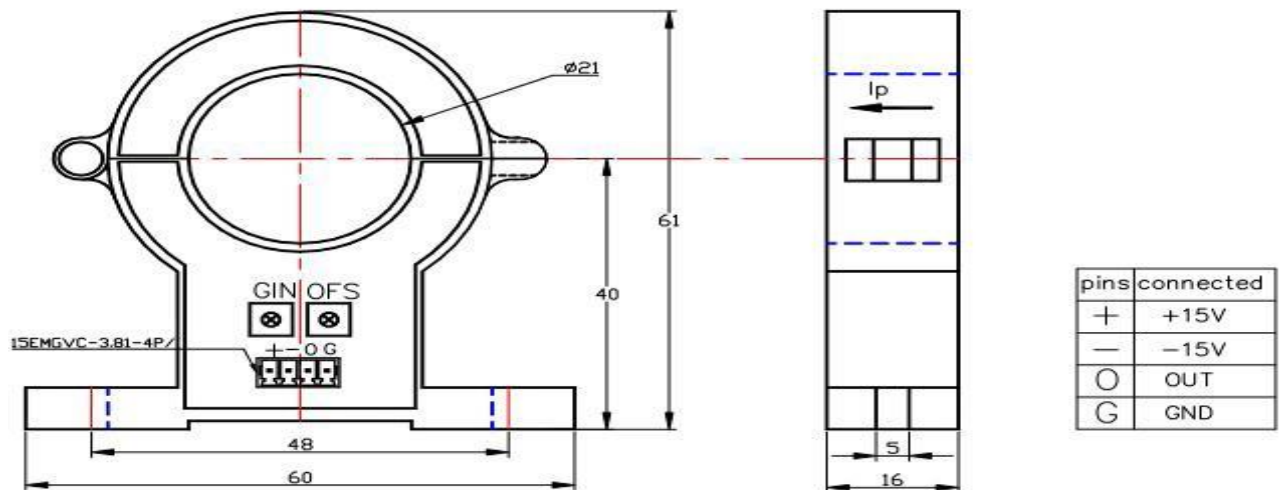

Remarks :

1. All dimensions are in mm.
2. General tolerance ± 1 mm.

Directions for use

1. When the current will be measured goes through a sensor, the voltage will be measured at the output end. (Note: The false wiring may result in the damage of the sensor)
2. Custom design in the different rated input current and the output voltage are available.

Standards

UL94-V0
 EN60947-1:2004
 IEC60950-1:2001
 EN50178:1998
 SJ20790-2000

General data

	Value	Unit	Symbol
Operating temperature	-40 to +105	°C	TA
Storage temperature	-40 to +125	°C	TS
Mass(approx)	72	g	M

Characteristics chart

Pulse current signal response characteristic

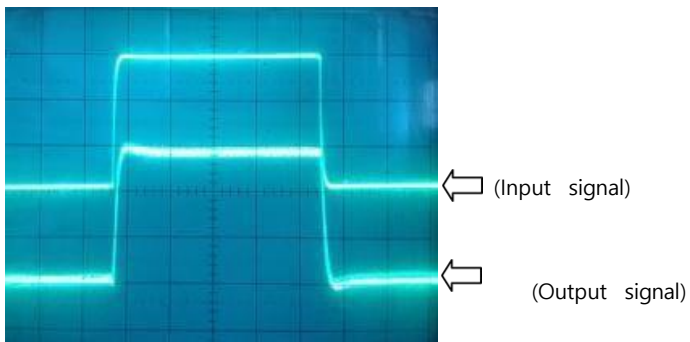

Effects of impulse noise

